

SFASU Summer Band Camps

2023 High School Band Camp Reminders



**STEPHEN F. AUSTIN
STATE UNIVERSITY**
NACOGDOCHES, TEXAS

Camp Reminders

Resident Camper Reminders

- What to Pack
- Residence Hall Reminders
- Resident Check-in

Commuter Camper Reminders

- Commuter Check-in

General Reminders

- Band Auditions
- Optional Private Lessons
- Theme Days
- Concert Schedule
- Checkout Procedure

STEPHEN F. AUSTIN STATE UNIVERSITY

Resident Camper Reminders

Commuter Camper Reminders: Slide 8
General Camp Reminders: Slide 10

STEPHEN F. AUSTIN STATE UNIVERSITY

Residence Hall Reminders

- ❖ During camp, you will stay in Residence Hall 14.
- ❖ Both male and female campers will stay here during camp but will be separated by floor.
- ❖ Hall 14 has communal bathrooms. Please plan accordingly.
- ❖ There are NO elevators.
- ❖ Click [here](#) to learn more about [Hall 14](#).



What to Pack

- ❖ When packing, please label or initial all of your personal belongings
 - SFASU is not responsible for lost or stolen items.
- ❖ Instrument with supplies (mallets, reeds, valve oil, etc)
 - Percussionists do not need to bring instruments with them. Please only bring your stick bag and practice pad.
- ❖ Modest, hot-weather, casual clothes - bring a school shirt to show your school spirit!
- ❖ A light jacket
- ❖ Hat and sunscreen
- ❖ Comfortable shoes - you will walk A LOT
- ❖ Twin size bed sheets, pillow with case, blankets
- ❖ Bathroom supplies - the dorms have communal showers
 - Toiletries, towels, shower shoes, hygiene products, etc
- ❖ Swimsuit with swim towel
- ❖ Pencil with notebook paper for your classes
- ❖ Umbrella, rain poncho, rain boots, etc - it may rain!
- ❖ Snacks and beverages if wanted - your dorm will have a fridge
- ❖ Extra money: snacks, water, SFA gear, etc

Band Camp Packing List

- Deodorant
 - Shower Shoes
 - Instrument and audition music
 - Comfortable Shoes
 - Umbrella
 - Jacket
 - Notebook and Pencil
- 

Dorm Check-in: 12 PM - 3 PM

- ❖ When you arrive to Hall 14, please park in the areas outlined in purple.
- ❖ After you have parked, please follow the sidewalks and arrows to the check-in entrance (see star).
- ❖ To enter Hall 14, campers must be present either a Dorm Fast Pass or a Registration Ticket from the Band Office.
 - Fast Passes were sent to the email provided on your student's registration form.
 - If your camper's registration is not complete, you must go to Cole Hall Lobby to finalize your student's registration.
 - After your full payment and waivers are complete, you will be presented a Registration Ticket to show at check-in.
- ❖ You may view the Hall 14 Floor Plan [here](#).
- ❖ For questions about your student's registration prior to check-in, please email bandoffice@sfasu.edu.

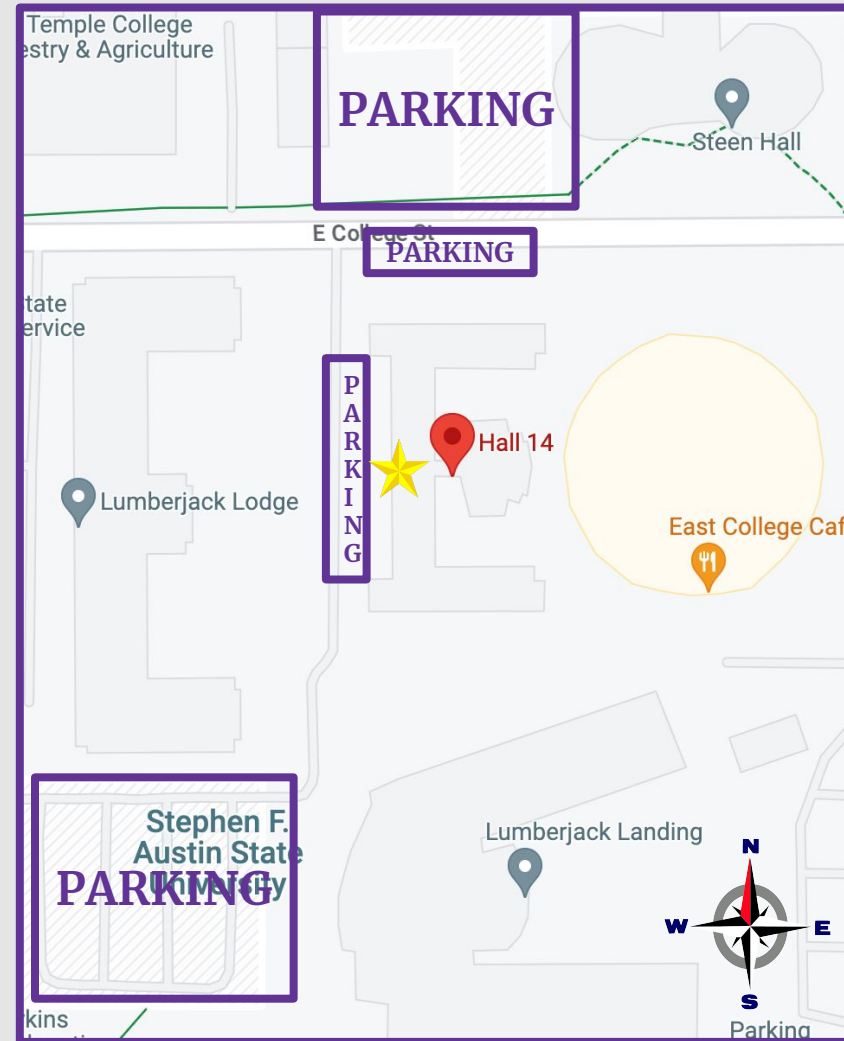

STEPHEN F. AUSTIN STATE UNIVERSITY

Dorm Check-in: 12 PM - 3 PM

- ❖ Once you enter Hall 14, please follow the flow of traffic.
- ❖ Due to the limited space in the lobby, we HIGHLY SUGGEST that you DO NOT bring your luggage in to check-in.
 - Please retrieve your luggage from your vehicle after you have checked in. You will enter the stairwell entrance with your luggage.
- ❖ At check-in, you will receive your dorm key and access/meal card.
- ❖ There will be a medication table at check-in. Please follow the steps below to drop off your student's medication.
 - Medication must be placed in a bag or container.
 - You must include a notecard with your student's name, medication instructions, and daily dosage.
 - Head counselors will provide the medication at the appropriate times for the camper to self-medicate.
 - Students will be able to receive over the counter medication during camp at the counselor's discretion.
- ❖ After you have completed check-in, please follow the sidewalk arrows outside Hall 14 to locate which side of the building your room is on.
 - Counselors will direct you to the appropriate stairwell entrance.
- ❖ Once you arrive to your room, your camp t-shirt, name tag, and handbook will be placed on your bed.
- ❖ After you PLACE your luggage, please head to the Wright Music Building for your audition. You must audition by 4 PM.

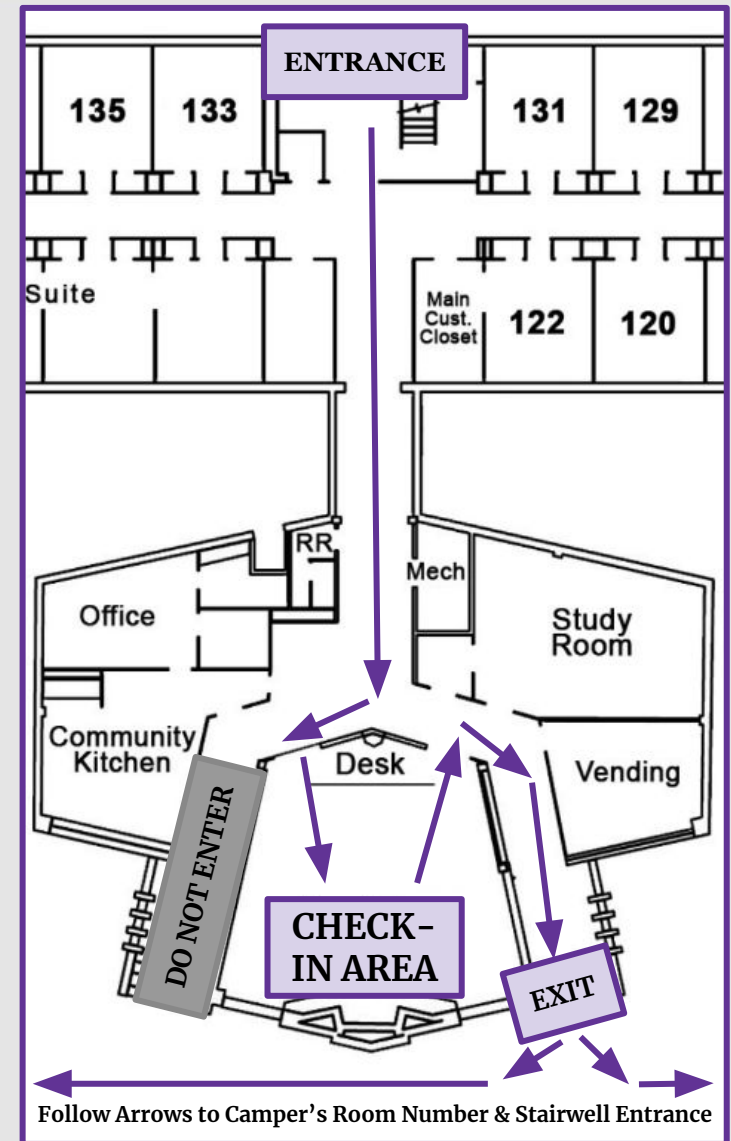

STEPHEN F. AUSTIN STATE UNIVERSITY

Commuter Camper Reminders

General Camp Reminders: Slide 10

STEPHEN F. AUSTIN STATE UNIVERSITY

Commuter Check-in: 12 PM - 3 PM

- ❖ Check in is from Noon to 3 PM in the lobby of the Wright Music Building.
- ❖ Please look for the “Commuter Check-in” sign. DO NOT enter the registration line in the Cole Hall lobby. There will be signs and counselors to point you in the correct direction.
- ❖ At check-in, you will receive your camp t-shirt, name tag, lunch meal card, and handbook.
- ❖ As soon as you check-in, please locate your audition room.
- ❖ You must audition by 4 PM.
- ❖ Commuters may go off campus for dinner or eat in the dining hall with the resident campers. If your commuter student plans to eat dinner in the dining hall, please bring \$11 to purchase dinner.
 - The commuter meal plan includes all lunch meals.
 - If commuters plan to eat off campus, please ensure they are back in the Music Building by no later than 6:45 PM.
- ❖ Please follow the schedule provided in your handbook for the remainder of camp.



STEPHEN F. AUSTIN STATE UNIVERSITY

General Camp Reminders

STEPHEN F. AUSTIN STATE UNIVERSITY

Band Auditions

- ❖ Your audition will be in the Wright Music Building, 2210 Alumni Dr. Nacogdoches TX, 75962.
- ❖ Band auditions are used to determine which ensemble your student will be the most successful in.
- ❖ There will be counselors and maps to help you locate your audition and warm-up room.
- ❖ You must audition by 4 PM. Residential campers CANNOT unpack prior to auditioning. You may return to your dorm to unpack after your audition is complete.
 - This is a strict deadline so we can ensure that band rosters are determined before your first rehearsal later in the evening.
- ❖ If your student is interested in Jazz Band, please take note that this is an additional elective that requires a separate audition.
 - Jazz Band rehearsals will take place during the student's free time.
 - Students may audition on a prepared piece or with their concert band audition music.
 - You must audition for a concert band prior to auditioning for the Jazz Band.
 - Jazz Band auditions will be from 3 PM to 5 PM on Sunday, June 11th.



STEPHEN F. AUSTIN STATE UNIVERSITY

Optional Private Lessons

- ❖ Private lessons are available with our applied faculty and staff. Private lessons will occur during the student's free time.
- ❖ There will be a private lesson enrollment table in the Wright Music Building lobby from 1 - 4 PM.
- ❖ Lessons are \$25 per half hour and are sponsored by Tau Beta Sigma. You can pay with exact cash, by check, or with a credit/debit card. Please note that a small processing fee will be applied per card transaction.
- ❖ Students are responsible for communicating with counselors about their assigned lesson times.
- ❖ Students are also responsible for keeping track of when their lesson is. No refunds will be given if a lesson is missed.



STEPHEN F. AUSTIN STATE UNIVERSITY

Theme Days

- ❖ Theme days are NOT required, but we highly encourage students to participate. Many of our faculty, staff, and counselors participate in them as well!
- ❖ Theme day items and apparel must align with the SFASU Code of Conduct. Failure to do so will result in the loss of theme days for all campers.
- ❖ Please ensure that you wear the appropriate footwear and warm weather clothing for camp as well.
- ❖ Monday: Meow, Meow, Monday - wear your best cat themed items. This could be cat ears, a cat shirt, or other cat themed apparel!
- ❖ Tuesday: Crazy Hat Day - wear your wildest, craziest, and funniest hat!
- ❖ Wednesday: Wave Pool Wednesday - wear your tropical vacation attire!
- ❖ Thursday: Superhero Day - wear your favorite superhero hat, shirt, or other superhero apparel!
- ❖ Friday: Concert Attire (Sunday Best) - you are not required to wear your concert attire all day, but please make sure you have your concert clothes ready to wear for your performance!



Concert Schedule & Checkout Procedure

FRIDAY CONCERT SCHEDULE

- ❖ The band concert schedule will be released no later than the first day of camp.
- ❖ At this time, concerts will occur between 11 AM and 3 PM.
- ❖ If you are unable to attend the performance, all concerts will be livestreamed.
- ❖ Please be sure to follow @sfasubandcamps on Facebook and Instagram for updates.

FRIDAY CHECK OUT PROCEDURES

- ❖ Your student will be assigned a check-out time depending on their schedule performance time.
 - Concert and check-out times will be set by no later than the first day of camp.
- ❖ If you are a commuter, please find your designated commuter check-out counselor. More information about this will be given at camp.
- ❖ Prior to check out, counselors will check the student's room for any room damages.
- ❖ All campers must check out by 3 PM.



STEPHEN F. AUSTIN STATE UNIVERSITY

We are so excited to see your musician at SFASU's High School Band Camp. If you have any questions, please contact us by emailing bandoffice@sfasu.edu or calling (936) 468-4702. Thanks, and Axe'em Jacks!



STEPHEN F. AUSTIN STATE UNIVERSITY