

SFA GARDENS ANNUAL REPORT SEPT 1 2014 – AUG 31 2015

INTRODUCTION

SFA GARDENS MAP

GARDEN GOALS FOR THE PAST YEAR – STATUS

GARDEN GOALS FOR 2015-16

PLANT SALE – FALL 2014 AND SPRING 2015

LES REEVES LECTURE SERIES

A PICTORIAL HISTORY – 2014-2015

DAVE CREECH

BARB STUMP

GREG GRANT

DAWN STOVER

ELYCE RODEWALD

KERRY LEMON

DUKE PITTMAN

BROCK VINSON



SFA GARDENS ANNUAL REPORT 9-01-2014 to 8-31-2015

Introduction

SFA Gardens, continues as a recognized center within Stephen F. Austin State University, Nacogdoches, Texas, USA. SFA Gardens is a multi-faceted public garden developed within SFA's Arthur Temple College of Forestry and Agriculture. The gardens are managed by Associate Director Dr. David Creech (1/2 time) and 4.5 FTE staff, both professional and classified, volunteers and student workers. SFA Gardens cover 68 acres on the SFA campus—10 acres in the Mast Arboretum and Jim and Beth Kingham Children's Garden, eight acres in the Ruby M. Mize Azalea Garden, eight acres in the Gayla Mize Garden, and 42 acres in the Pineywoods Native Plant Center and Jimmy Hinds Park. SFA Gardens plays a role in the maintenance and development of the 60-acre SFA's Recreational Trails and Gardens, which is adjacent to the Gayla Mize Garden.

Community support is provided by a "Friends of SFA Gardens" group with about 200 members and the SFA Gardens Advisory Board, which meets quarterly. SFA Gardens enjoys a great corps of volunteers. In the past year, our Volunteer Corps generated 3367 hours, worth \$75,605. While State of Texas funding assists with operations and maintenance expenses, the gardens staff raise significant funds through two plant sales per year, a robust grant-seeking effort, and six endowments that support the gardens. A major capital campaign raised about \$1 million dollars from private donors and Texas foundations to build the Ina Brundrett Conservation Education Building at the PNPC. The building demonstrates environmentally sensitive methods of construction and operation. A successful proposal to the Sun Club of Green Mountain Energy, Austin, Texas, led to a solar array which, by our latest estimates, provides about 60 percent of the structure's energy needs.

A new development, the Jimmy Hinds Park, received funding in the past year from Barbara Finney, who was the daughter of Jimmy Hinds, the first Agricultural Professor at SFA. That gift will allow the development of a high visibility garden on a well-travelled thoroughfare in Nacogdoches, Austin Street. Development of this two acre property (North end of the PNPC on Austin Street) began in the past year.

Plant diversity and adaptability are key focal points in developments in each of the four main gardens, offerings in the two plant sales, and in the public outreach by staff through lectures, public events, publications, and tours. Environmental education for future generations is another main initiative that reaches nearly 20,000 a year in a broad spectrum of programs for ages K-adult.



ARTHUR TEMPLE COLLEGE OF FORESTRY AND AGRICULTURE
Stephen F. Austin State University
Nacogdoches, Texas

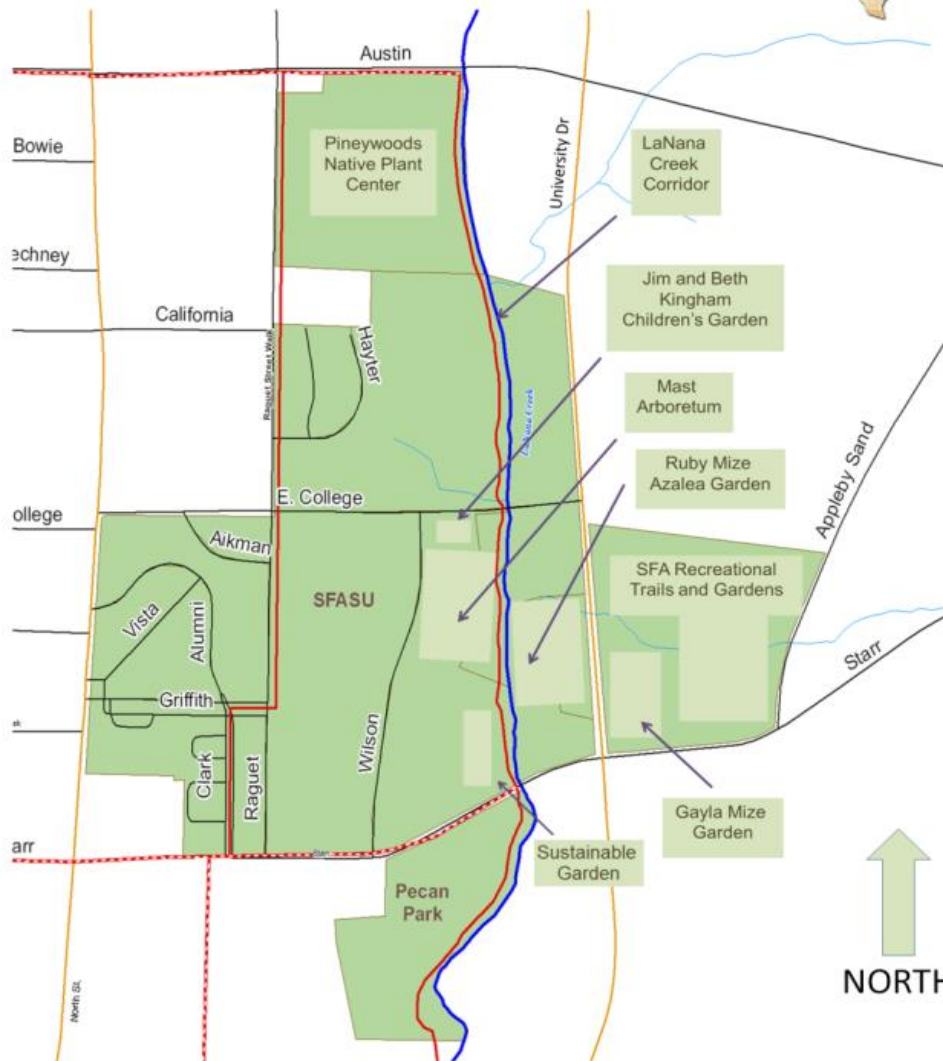

LaNana and Banita Creek Trail System		Date: July 25, 2013
<p>CASTILAW ENVIRONMENTAL SERVICES, LLC NACOGDOCHES, TX 75701-8901 SULPHUR SPRING, TX 75482-0204</p>	<p>City of Nacogdoches Nacogdoches County, Texas</p> <p>Created By: Neil Boitnott, Austin Russell, & Adam Miller</p>	<p>Trail System</p> <p>Existing - 5.4 Miles Proposed - 2.7 Miles Areas of Interest</p>
		<p>Highways Streets Major Creeks Minor Creeks</p>

Data Source: CES &
City of Nacogdoches
Datum: NAD 83

Gardens Goals for the Past Fiscal Year 2014-2015

Mast Arboretum

Continue cooperation with colleagues and friends in the Art Department and the community to create a high profile Sculpture for All juried competition in the Mast Arboretum and Ruby Mize Azalea Garden. SUCCESS

Conduct regional native grass trial; trials of blueberries, pomegranates, kiwis, and with the Takii Corporation, canna hardiness. CHANGE IN PLANTING LOCATION - IN PROGRESS

Do a better job of posting plant performance information on the web. Improve reporting. NOT ACCOMPLISHED

Design new Children's Garden area on north side of Mast Arboretum by College Avenue and develop a campaign to get it funded. NOT ACCOMPLISHED – CAMPAIGN NOT APPROVED

Improve Elking Environment on southern side of Mast Arboretum. SOME PROGRESS, NOT ACCOMPLISHED

Improve Ruth Williamson, Herb Garden and Elking Environment. DONE

Treat the wood in pavilion in the Jim and Beth Kingham Children's Garden. NOT ACCOMPLISHED

Paint the outdoor classroom floor in the shade garden. NOT ACCOMPLISHED

Add nursery space on East end of N shade house by taking out deodar cedar and building a pad – CANCELLED DUE TO NEW REALITY

Expand Kiwi planting – IN PROGRESS

Take a leadership role in managing the new nursery at Grounds. DONE

Take a leadership role in the Mum evaluation plantings at the Gayla Mize Garden. - DONE

Develop the rectangular plot on the South side of the Jim and Beth Kingham – IN PROGRESS

Children's Garden Pavilion. IN PROGRESS

Develop a database for plants being trialed for companies. DONE

Develop a plan for improving the “look” of the front compartment of the glasshouse and implement it. IN PROGRESS

Develop a location for taking care of cuttings that are coming out of the mist bed. DONE

Install a time clocked watering system for the South Shade House nursery. DONE

Add controllers and time clocks in the North Shade House nursery DONE

Continue to improve our social media presence with timely Facebook posts . . . Dawn and Dave - DONE

LaNana Creek Corridor

Add new *Taxodium* genotypes where space allows (Mast Arboretum and Ruby Mize side needs a transfusion) – NOT ACCOMPLISHED

Pruning lower limbs. DONE

Collect data on two *Taxodium* research projects. DONE

Continue brush control on banks of creek. DONE

Continue timely weed control applications. DONE

Ruby M. Mize Azalea Garden

Finish Garden shed and use it – paint the door. Put a good door knob on the building. DONE

Add more plant labeling. WORK IN PROGRES

Continue support of Nacogdoches Azalea Trail activities. DONE

Continue support of Little Miss Princess Tea Party. DONE

Move the nursery out of the Tower area – NOT ACCOMPLISHED

Work with the administration to see if there's a mechanism to move the ROTC tower to a more suitable location. FAIL

Work with Grounds to develop a plan to clean up the Heavy Equipment Yard area. FAIL

Pineywoods Native Plant Center (PNPC)

Propagate and grow as many saleable plants as possible to produce two successful plant sales to support the year's financial needs of the PNPC. DONE

Hire up to 10 student workers to help maintain the 42 acre PNPC grounds and nursery facility. DONE

Install faucets in the CEB landscape. DONE

Repair the broken bridge in bottom land. DONE

Develop a parking plan to allow vertical parking. NOT ACCOMPLISHED

Coordinate installation of three lights for the CEB. DONE

Installation of gutters and rainwater capture – GUTTERS UP, RAINWATER TANKS TO BE INSTALLED NEXT YEAR

Have signage made for visitor instructions, parking, etc. NOT ACCOMPLISHED

Manage blueberries and muscadine plantings. DONE

Complete *Ilex decidua* collection. IN PROGRESS

Enhance CEB landscape and improve sod. DONE

Continue to battle Chinese privet, Chinese tallow, and other invasive plants in the Tucker Woods. NEEDS ATTENTION

Install time clocks and controllers on the nursery DONE

Develop a native plant list and then implement a plan to increase native plant diversity at the PNPC – focus on collections, new plants. NEEDS WORK

Jimmy Hinds Park Project – boardwalk connections to treehenge and computer shack parking lot. DONE

Install irrigation system and benches at Jimmy Hinds Park. Vineyard DONE

Gayla Mize Garden

Continue the application of crushed asphalt to trails. DONE

Barb continues to map and label. DONE

Again, find a creative way to finish the pavilion in the Gayla Mize Garden – adding a roof – NOT ACCOMPLISHED

Crinum collection expanded and labeled. EXPANDED, NEED METAL LABELS

For Mum collection and other color, expand the entire front line of weeping balds. IN PROGRESS

Finish planting the few open areas left. NOT ACCOMPLISHED

Add tours of this garden to annual Azalea Trail tours. DONE

Environmental Education Program

Continue environmental education programming, wide-ranging horticultural outreach through speaker series at SFA and in other gardening venues across the US. DONE

Implement program assessment for all public programs. DONE

GOALS FOR 2015-2016

MAST ARBORETUM

HIGH PRIORITY: Dawn/Dave/Greg - Seek approval and find funding for 8000 square feet of greenhouse space to be placed at PNPC – begin to transition all staff to PNPC as headquarters for SFA Gardens

Pittman/Creech: Roof on the GM Gazebo – add the eight rafters that are under the Ag building – in-house roof creation

Creech/Dawn: Pecan variety planting at Pecan Acres Park – a City/SFA Gardens collaboration

Creech: Continue Acer skutchii evaluation at the SRC and replant any losses.

Creech/Greg: Add two rows of blueberry germplasm to the plots at the N end of the PNPC and tie in to existing irrigation system.

Creech/Greg: Now that gutters are installed, design and install rainwater capture at the Ina Brundrett Conservation Education Building

GM Garden plantings expanded – GM Garden drainage project –

Pittman/Creech: Expand Kiwi Evaluation Plots

Creech: Expand Coliseum Parking Lot plantings

Dawn/Greg: Expand Wildflower Plantings along Starr Avenue – augment with plugs of appropriate perennials – develop signage

Work with Physical Plant and donor to get GM Well Water to RM Garden

Increased focus on pollinator/prairie habitat creation at the SFA Gardens. Search for grants and other sources of funding to facilitate this goal.

Develop a Wildflower PVC sign and install there.

Continue to expand woody plant and hardy chrysanthemum trials – post excel files and data collection on web.

Host second Industry Day event in June 24, 2016

PNPC and JIMMY HINDS PARK

Expand and enhance the profile of the PNPC's rare, threatened, and endangered plants conservation program utilizing the Elisabeth Montgomery Endowment.

Assist campaign for new horticulture greenhouse facilities for SFA Gardens.

Make at least 20 K at both spring and fall sales.

Replace plants lost in 2015 drought.

Trail maintenance

Repair and enhance landscape irrigation.

Expand nursery herbaceous pad.

Replace GH mist nozzles.

Develop a parking plan to allow vertical parking.

In bottomland, create 5 glades . . . sunlit circles already located, to be planted in winter 2016.

Plant more bald cypress down Sara's branch in appropriate spots and provide chicken wire tubes for protection from deer.

Paint the new Jimmy Hinds Park boardwalk floor

Repair bridges and boardwalks in the PNPC with paint and grit.

Return to an annual Privet control effort in bottomland.

Benches at JH Park placed – Interpretive sign at JH Park placed

New red iron ore rock trails at JH Park expanded

Structure on Oxbow Island at JH Park created with seating

Oxbox planting with wetland plants

Muscadine Grape Vineyard at Jimmy Hinds Park built, planted and with irrigation.

Signage for the muscadine planting.

Elyce Rodewald

Focus on vegetable gardening with after-school program

Increase education assistant position to full time in order to maintain current level of educational programming

Kerry Lemon

Help develop program for gardening with youth.

Assist in developing positions and job descriptions to maintain current level of educational programming.

Assist in development of curriculum with a focus on endangered plant species for summer camp and third grade field trips.

Organize educational programming files and create curriculum folders for after-school activities.

FALL 2014 AND SPRING 2015 PLANT SALES

SFA Gardens hosts two plant sales per year. They serve as a major source of funding for staff salaries and program development.

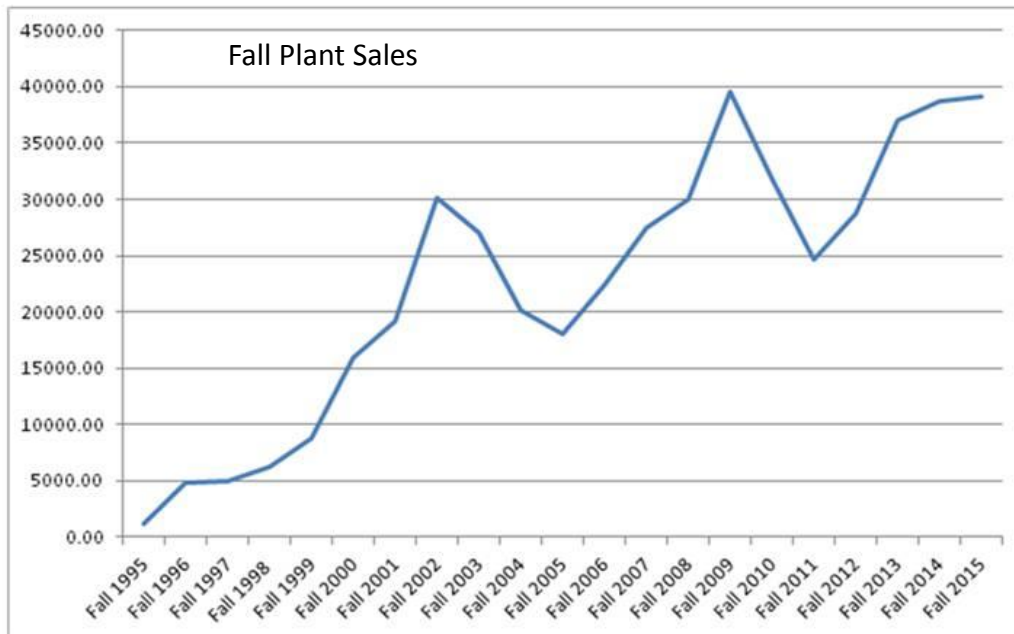
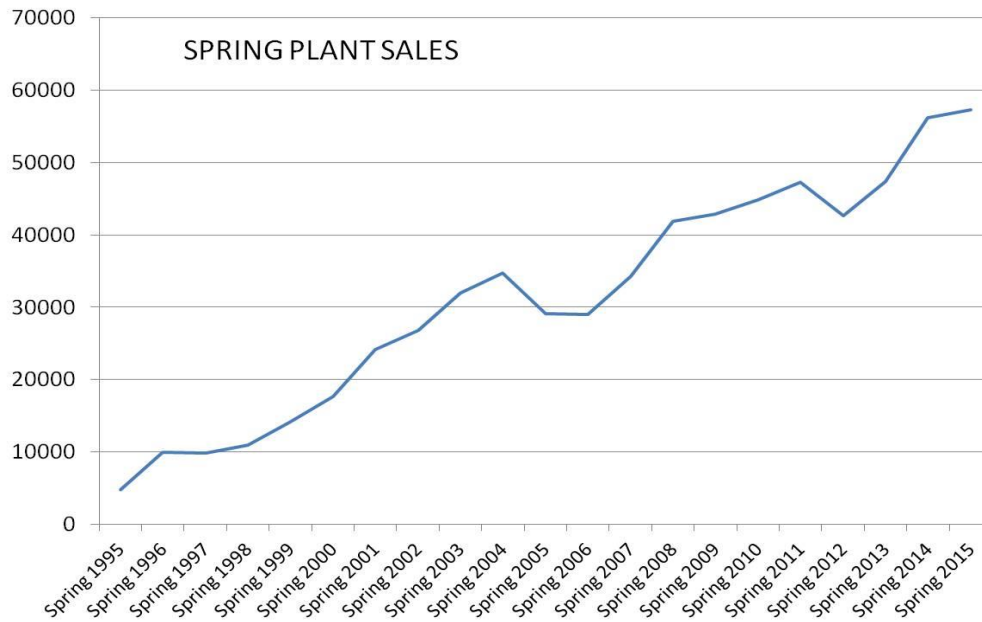

THE 2014-2015 LECTURE SERIES

SEPT 11 – Dawn Stover and Greg Grant. “Upcoming Plant Sale Preview – Picking the Best of the Best.” – dawnstover@sfasu.edu – ggrantgardens@yahoo.com

OCT 9 – Patty Leander, Texas Gardener - “Goodness from the Vegetable Garden: Enjoying the Fruits – and Roots, Seeds, Leaves and Flowers - of Your Labor”.

NOV 13 – Jenny Wegley, Dallas Arboretum – “I think if I hear the word “Color” one more time, I’m changing my profession.” Email: jwegley@Dallasarboretum.org

DEC 11 – Dave Creech, SFA Gardens – “The true and unabridged story of this past year.” Email: dcreech@sfasu.edu

JAN 8 – Tony Napolillo – Why Solar is the Future of a Sustainable World – Sun Club Program Manager, Green Mountain Energy Company, Austin, TX
tony@GreenMountain.com

FEB 12 – Jared Barnes - Headed Down South from the Land of the Pines: Reflections on the Plants, People, and Places of North Carolina – Asst Professor, SFA, Nacogdoches, TX – barnesj@sfasu.edu

MAR 12 – Yalma Luis-Rodriguez – The Amazing, Rare, and Beautiful Mexico Mountain Sugar Maple. Professor, Louisiana State University, LSU, Baton Rouge, LA - yvarga1@tigers.lsu.edu

APR 9 Matt Welch – Plants, Planting, and Pushing the Envelope in Austin landscapes. Maldrone Group, Austin, TX - matt.welch@maldroneldc.com

MAY 14 – David Leedy – Can I interest YOU in an Aroid?- Horticulturist, retired, Fort Worth, Texas - djleedy@sbcglobal.net

JUN 11 Tim Hartmann – Gardening for Food or Beauty; Why not Both? - Extension Program Specialist, TAMU, College Station, TX - Timothy.Hartmann@ag.tamu.edu

JUL 9 – Justin Scheiner – Grapes for Table and Wine – can both fit in Texas?
jscheiner@tamu.edu

AUG 13 Scott McMahan - Climbing Asian Mountains, Fording Rivers, and Fighting the Elements; Moments from a Plant Hunter's Diary. Owner, McMahan Nursery, Atlanta, Georgia - smcmahan@bellsouth.net

SFA GARDENS - A PICTORIAL HISTORY – SEPT 1, 2014 TO AUG 31, 2015



We start off the year with a first for Texas – the first ever crop of Golden Kiwis! We picked September 19, 2014. *Actinidia chinensis* ‘Golden Dragon’ produced over 145 lbs of delicious fruit from eight vines. The male plant, ‘CK3’ served as the pollinator. These are patented clones out of Auburn University. Is Golden Kiwi a potential crop for Texas? Maybe.



A great day for a plant sale. Our Fabulous Fall Festival Oct 4, 2014 brought in a great crowd, some terrific plants.



Osmanthus fragrans ‘Aurantiacus’ is a golden flowered sweet olive, in bloom in the garden October 16, 2014. One of our favorite small evergreen flowering trees.



The perennial garden mum trial was in fine show Oct 24 2014. This trial in the front entrance of the Gayla Mize Garden is a Dawn Stover directed project. We're acquiring, evaluating and promoting Texas tough-easy to return - perennial mums for the garden.



A group shot of the SFA Gardens staff with everyone smiling 11-18-2014. Left to right: Kerry Lemon, Elyce Rodewald, Greg Grant, Brock Vinson, Dave Creech, Duke Pittman, Dawn Stover, and Barb Stump.



Camellia japonica 'Hana Jiman' is one of our favorite camellias. In glorious bloom at the Gayla Mize Garden 11-11-2014



Acer palmatum 'Sango Kaku' next to the Physical Plant building in the Mast Arboretum – a tree off irrigation for a decade – and it's never cared. 11-22-2014



By less than popular demand, we've planted another treehenge at the Jimmy Hinds Park – another circle. This time we're using *Taxodium* X 'Banita' (AKA T502) in our closely spaced circle. Our plan is brilliant. In a few years we will get a rope, circle the trees at the top and with a come-along, we'll pull them all together to make a circular teepee. At least that's the plan. 12-17-2014



Duke Pittman and Brock Vinson taking data on a study 01-14-2015 to determine the effects of three pruning strategies on three clones of *Taxodium*, bald cypress: 1) cutting all branches back to the central leader, 2) cutting back branches half way, and 3) unpruned. After three years, results indicate best form and plant height was associated with treatment moderately pruning the tree back, treatment 2.



Duke and Brock taking care of a tree fall in the Gayla Mize Garden. This is a get 'er done bunch. 01-15-2015



"Looking Back" is one of the pieces that is now a permanent fixture at the Ruby M. Mize Azalea Garden



Phlox nivalis ssp. *texensis*, Texas Trailing Phlox, at the PNPC. An endangered species, part of the SFA Gardens "Three R's" program - Rescue, Research, and Reintroduction.



02-09-2015. Louis Duffield on FM 225 on the SW side of Nacogdoches is now a new cooperator in our blueberry germplasm evaluation program. While we've had a few setbacks in the past year (water quality), we are poised for a great 2016.



02-11-2015. It's controlled burn day at the PNPC. With cooperation from the Texas Forest Service, the Nacogdoches Fire Department, and SFA's Arthur Temple College of Forestry and Agriculture faculty we set the marsh on fire at the Pineywoods Native Plant Center. Forestry students came over for the event and no students or wildlife perished.



Edgeworthia chrysantha 'Snow Cream' at the Mast Arboretum in fine show 02-15-2015. This is a fragrant deciduous shrub that blooms on bare stems in the winter. The stems are pliable and in China they are often tied in "love" knots to commemorate a marriage, young people in love, or a death in the family.



02-27-2015. SFA Gardens hosts the annual conference of the Texas Association of Botanical Gardens and Arboreta, an eclectic gathering of Directors and staff from many gardens in the state.



This is becoming more and more the picture of our newly established trees. Deer damage in the past two years has been intense. With no control allowed by the authorities, this is what we now face. Deer find our city a pleasant place to live, browse and make twins. The bucks thrash our young trees and shrubs, many killed to the ground. Our only recourse is a time consuming, labor costing tree wrap of chicken wire tubes. While it works, it's unsightly, but it does give us some protection for the first few critical years of plant establishment. We evidently have no choice. Don't ask us what we think about wild pigs.



03-10-2015. Nacogdoches gathered together to honor one of our favorite citizens, Dr. F.E. Abernethy. With 400 in attendance, Banita Creek Hall was packed. “Ab” was SFA’s resident scholar, English Professor, author, spelunker, guitar picker, singer, WWII vet, and the great trailblazer in our community. He’s the Father of the LaNana and Banita Creek Trail system. Dr. Creech’s tribute to this amazing man can be found here: <http://sfagardens.sfasu.edu/images/stories/PDF/TRIBUTE%20TO%20AB.pdf>



March 17, 2015 was the kickoff day for the Sculpture for All exhibit. This juried show leaves ten pieces in place for 18 months and brings an exciting revolving door feature to the gardens – and a whole new different crowd of enthusiasts to the garden. Sculpture for All is the collaborative brainchild of Jeff Brewer, Art, and Dawn Stover, SFA Gardens. This piece is titled ‘West Texas Shaman’ and is the work of Joe Barrington, Throckmorton, TX.



03-26-2015. SFA Gardens hosted the National Azalea Society Conference with a great lineup of speakers, 88 attendees from across the nation, a terrific plant sale, and our garden in fine form.



We aren't sure if we could have a more beautiful garden. The Ruby Mize Azalea Garden is an 8-acre jewel on the LaNana Creek necklace. We're all about diversity, every color in the rainbow, no weeds in sight, and perhaps the finest collection of azaleas, Japanese maples, and camellias in the South.
04-03-2015



Spring Garden Day Plant Sale 04-11-2015. Another great crowd and barn burning plant sale.



04-11-2015. We wake up to realize we have a second crop of Golden Kiwis on the way!



04-28-2015. Brock, Duke and our good friends from the Physical plant all working together to build a watering system around the Ina Brundrett Conservation Education Building.



05-18-2015. Our brand new *Hydrangea macrophylla* evaluation program is off the ground. This is an old timer, 'Amethyst' – we are testing over a 100 varieities in the Gayla Mize Garden with a focus on the newer reblooming types.



June 18, 2015 – Miss LaNana shows her wrath – one of our worst ever floods. The garden is a mess. Is it El Nino? Is it global warming? Is it the Dr. Creech's karma? Floods like this here are normally an every four to five year event. Something has changed?



June 18, 2015. Two of our student workers, Hunter and Sam express their concern about the wisdom of gardening in a flood plain. Fortunately, staff have seen it before and understand that it's not the end of the world. The flood recedes and everyone piles into the garden to fight the snakes, fireants, pull debris away, and remulch. Gardeners are stubborn.



June 19, 2015. The flood has gone away. While the cleanup will take weeks, there are so many parts of the garden that say, "My goodness, what a nice rain."



June 22, 2015. Sarah Weatherford, student worker, giving the “Axe em Jacks” hand sign in our Gayla Mize Garden perennial mums trialing area. That’s *Lilium formosanum* behind Sarah is certainly in fine form!



June 25, 2015 image of our *Acer skutchii* plots at the Science Research Center on the Loop. The Mexico Mountain Sugar maple is proving to be Texas tough, extremely drought resistant and alkaline tolerant. We’re off irrigation now and the trees are on their own. They’ll survive in fine form. First selections are being made and they root!



07-07-2015. Another bucket list tree for the record books. Is this the first *Franklinia alatamaha* tree to bloom in Texas? We have killed many of these over the years. Extinct in the wild, prone to die, the Gayla Mize Garden is home to an 8' tree that has now bloomed two years in a row!



06-26-2015. Our very first "Industry Day" was titled "Wild about Woodies". In the morning, about 65 nursery and landscape professionals toured the gardens. In the afternoon, our speakers were Allen Owings (LSU), MengMeng Gu (TAMU), Dave Creech (SFA), and Brent Pemberton (TAMU).



06-26-2015. SFA Alumni who were part of the very first Industry Day, "Wild about Woodies" conference. Greg Grant isn't an alumni but he likes his picture taken.



07-09-2015. These are the new black leaf crape myrtles in our trialing area by the Coliseum parking lot. There are now 15 varieties of crape myrtle with black leaves. Charlie Hall, TAMU, calls it the hypercompetition of our industry. Hey, isn't it hard to believe these were underwater just three weeks ago?



Aug 2015. Tecoma stans 'Gold Star', a Greg Grant introduction remains the gold standard for Tecomas. Floriferous, Texas tough, and a reliable returner year after year. These four containers are at the back door of the Tucker house, PNPC, and provide a long cheerful hello to our visitors.



Aug 2015. Yuhong Zheng 'Jade', Associate professor, Ornamental Plants Research Center, Institute of Botany & Jiangsu Province and Chinese Academy of Sciences, Nanjing China is our visiting scientist for the year. She is working on SSR and ISSR genetic analysis of Teaxodium. Daughter Surri is at Mike Moses Middle School, and in typical China fashion, making friends, doing very well, and loving that there's less homework than back in Nanjing!

Moody Gardens Project was approved by the Moody Foundation in Spring of 2015. This is a three year project:- “Acquiring, Evaluating and Promoting Salt- and Hurricane-Tolerant Plant Materials for Galveston Island, Texas”. Faculty members involved include Drs. Dave Creech, Leon Young, Ken Farrish, Michael Maurer, Dave Kulhavy, Yanli Zhang, Dan Unger, Steve Wagner. Grad students Elaine Harris, Elaine Fowler, and Rebecca Burnett with thesis projects. Check out our new webpage: http://sfagardens.sfasu.edu/index.php?option=com_content&view=article&id=49&Itemid=41



Saving the best for last and perhaps the only truly significant thing we do. The SFA Gardens Environmental Education program touches the lives of over 13,000 young kids every year – introducing them to the wonders of nature, the importance of conservation, and an appreciation of our natural heritage. Elyce Rodewald and Kerry Lemon are leading the charge on this important work.



DAVE CREECH (Sept 1, 2014 – Aug 31, 2015)



International

China, Aug 12 – Sept 2, 2015.
Consultancy to China - working with Professors Yin Yunlong and YuHong of the Nanjing Botanical Garden, Nanjing, China. Presented five seminars seminars - 166 total in audience.

Presentations

Creech, David. 2014. Fifty Plants you shouldn't live without. Harris county Plants Conference, Houston, TX, Sept 12, 2015 – 96 in attendance

Creech, David. 2014. China Connection – Camellias from a Faraway Land. Presentation to the Gulf Coast Camellia Society, Hammond, LA, Oct 17-18, 2014. 88 in attendance.

Creech, David. 2014. The Maple Collection at SFA Gardens. Presentation to the Southern Region International Plant Propagators Society annual conference, Hickory, NC, Oct 25-29, 2014. 205 in attendance.

Creech, David. 2014. Best Maples for East Texas Gardens. Garden Clubs of Texas, Fall District III Meeting, Palestine, TX, November 13, 2014. 122 in attendance.

Creech, David. 2014. Japanese maples for East Texas Gardens. East Texas Gardening Symposium, Tyler, Texas, November 15, 2013. 56 in attendance.

Creech, David. 2015. The Natives are Restless. Montgomery County Master Gardener Training, Conroe, TX. Jan 20, 2015. 62 attendees.

Creech, David. 2015. Hydrangea species, varieties, marketing. Presentation at the Educational conference of the Gulf States Horticultural Expo, Mobile Alabama, January 28-29, 2015. 110 participants.

Creech, David. 2015. Influence of Three Pruning Strategies on Growth and Form of Three Taxodium Clones. Oral paper to the American Society of Horticultural Science Southern Region conference, Atlanta, Georgia, Jan 30 – Feb 1. 26 in audience.

Creech, David. 2015. Trees for a 21st Century Texas. Presentation to the 2015 North Central Texas Urban Forestry Conference, Feb 20, 2015. Grand Prairie, TX. 158 in attendance.

Creech, David. 2015. Blueberries, Blackberries, and Kiwis. Presentation to the annual East Texas Fruit and Vegetable Conference, Nacogdoches, TX. Feb 24, 2015. 85 participants.

Creech, David. 2015. Tour of PNPC, Arboretum, and Azalea Garden for students and faculty members visiting SFA from the Älvdalen Educational Center in Älvdalen, Sweden. 17 participants.

Creech, David. 2015. Welcome and The Year in Review. Presentation to the annual conference of the Texas Association of Botanical Gardens and Arboreta – hosted this year at SFA Gardens, Nacogdoches, TX. Feb 25-27, 2015. 85 participants.

Creech, David. 2015. Trees and Shrubs for the Pineywoods. Presentation to the Sabine Parish Master Gardeners, Cypress Creek Resort, Many, Louisiana. Feb 28, 2015. 222 participants.

Creech, David. 2015. A tribute to Ab – trailblazer. Emcee and seven minute tribute to Ab at the event honoring Dr. F.E. Abernethy, trailblazer and father of the LaNana and Banita Creek trail system. March, 3, 2015. 400 in attendance.

Creech, David. 2015. Received “The Special Friend of Azaleas Recognition” Award from the Azalea Society of America, a surprise during the banquet of the Azalea Society of America Conference. Nacogdoches, TX. March 28, 2015. 90 in attendance.

Creech, David. 2015. Introduction to SFA Gardens. Presentation to the Azalea Society of America Conference. Nacogdoches, TX. March 28, 2015. 88 in attendance.

Received the Special Friend of Azaleas Recognition by the Azalea Society of America Mar 28, 2015

Creech, David. 2015. Tour for the Smith County Master Gardeners. April 6, 2015. 18

Creech, David. 2015. Kiwanis. 10 participants.

Spring Garden Gala Day Plant Sale. April 11, 2015. \$57312.

Creech, David. Tour of SFA Gardens. Dr. Mike Arnold, TAMU Horticulture Professor, and his class of Landscape Plant Materials. April 10, 2015. 8 participants.

Sculpture for All reception and opening. April 17, 2015.

May 22 – 27, 2015. Visitors from China. YongFeng Nursery. 2

June 1-16, 2015. Board of Directors meeting for International Plant Propagators Society Southern Region. Chatanooga, TN. 12 in attendance.

June 25, 2015. A presentation to the Temple Board on SFA's Environmental Education program. 12 in attendance.

June 26, 2015. Wild about Woodies Industry field day. Presentation to industry only invitees at SFA Gardens. 65 participants.

July 13-15, 2015. Hydrangea Culture Just This Side of Hell; A Synopsis From East Texas. Presentation to the International Hydrangea Society, Cape Cod, MA. 110 participants.

July 16-17, 2015. New, Interesting and Underutilized Woody Ornamentals for Zone 7. Swarthmore College Woody Ornamentals Conference, Swarthmore, PA. 511 participants.

July 20-24, 2015. Lessons Learned After Thirty Years of Plant Evaluation At SFA Gardens – A Retrospective. Presentation at Southern Nurserymen's Association Conference, Atlanta, GA. 31 participants.

Total 2769

Publications

Creech, David. 2014. Shrub Evaluation at SFA Gardens. Proceedings of the International Plant Propagators' Society 63: 457-462.

Creech, David. 2015. *Acer saccharum* ssp. *skutchii*, the Mexican Mountain Sugar Maple. SNA Research Conference Proceedings Vol. 59: 197-213. (<http://www.sna.org/Resources/Documents/14resprosec07.pdf>)

Creech, David. 2015. The Japanese Maple Collection at SFA Gardens. Proc. International Plant Propagators Society 64: 427- 429. ISBN 978-94-6261-080-4

Creech, David. 2015. Notes from the Director. Summer 2015 SFA Garden News 10 (3)
<http://sfagardens.sfasu.edu/images/stories/PDF/summer2015%20newsletter.pdf>

Creech, David. 2015. Notes from the Director. Spring 2015 SFA Garden News 10 (2). 1-2

(<http://sfagardens.sfasu.edu/images/stories/PDF/spring%202015%20newsletter%20final.pdf>)

Creech, David. 2014. Notes from the Director. Winter 2014-2015 SFA Garden News 9 (4): 1-2.

[http://sfagardens.sfasu.edu/images/stories/PDF/winter2014-15%20\(1\).pdf](http://sfagardens.sfasu.edu/images/stories/PDF/winter2014-15%20(1).pdf)

Creech, David. 2014. Notes from the Director. Fall 2014 SFA Garden News 9(3): 1-2

<http://sfagardens.sfasu.edu/images/stories/PDF/fall2014.pdf>

Creech, David. 2014. Notes from SFA Gardens – Is Redbud The New Crapemyrtle? TNLA Green Vol 16 (6): 37-39.

(http://www.tnlagreen.org/tnlagreen/november_december_2014?pg=37#pg37)

Creech, David. 2015. Notes from SFA Gardens: Japanese Maples – The Aristocrat of Small Trees. TNLA Green Vol 17 (1):47- 49.

(http://issuu.com/tnla/docs/jan_feb_greendigital2/47?e=8525810/11205971)

Creech, David. 2015. Notes from SFA Gardens: SFA Gardens to Host First Horticulture Field Day for Industry Professionals. TNLA Green Vol 17 (2): 27-29.

(http://www.tnlagreen.org/tnlagreen/march_april_2015?pg=27#pg27)

Creech, David. 2015. Influence of Three Pruning Strategies on Growth and Form of Three Taxodium Clones David Creech SFA Gardens, Dept. of Agriculture, 1924 Wilson Dr., Stephen F. Austin State University, Nacogdoches TX 75962-3000. **HortScience** 50(9) (Supplement)—2015 SR-ASHS Annual Meeting—30 January–1 February 2015 S33

Barbara S. Stump—SFA Gardens Development

Annual Report—September 1, 2014-August 31, 2015

Progress Toward Goals for 2015 Fiscal Year

While Barbara officially retired from SFA at the end of Fiscal Year 2015, the following includes projects from her last year at SFA Gardens.

For Ruby M. Mize Azalea Garden

Create a new event for fall to draw visitors to learn more about Japanese maples.—
Nacogdoches Convention and Visitors Bureau is advertising Fall Foliage tours and has asked for tour guides for this. Mast Arboretum and Gayla Mize Garden likely to be included depending on fall color status and tourists' time available.

Fully support annual Nacogdoches Azalea Trail led by Nacogdoches CVB. The CVB included our tea party and convention events at their expense on their brochure that was distributed widely. We provided guides tours for 10 tours to a total of 454 visitors. Need to increase promotion of Azalea Trail events so annual Symposium and Little Princess Tea Party make money. Also, this spring was cold, so the 2016 Azalea Trail has been moved back to warmer period: mid-March through mid-April. I hope to help with tours as a volunteer in 2016. No sponsor was secured for 2015, so the event was basically cost-recovery. We did not evaluate proposal to charge for guided Azalea Trail tours, especially since these are typically organized by the Nacogdoches CVB, which only charges for their historic on-bus captains. Tour numbers were:

The national Azalea Society of America national convention substituted for the annual azalea symposium, March 26-29, 2015. We had 88 attendees from 11 states besides Texas — including two from New Hampshire! We made a profit of approximately \$4,000, plus paid back the initial \$3,000 in “seed money” we used from the Mize Wisely Azalea Garden Endowment Fund to pay up-front costs. We used the new Ina Brundrett Conservation Education Center on campus for the speakers' sessions at night and the Saturday lunch, as well as the Texas Chapter of the ASA held their plant sale which made a profit of approximately \$3,500 for the chapter as well.



Both SFA and off-campus resources were used for transportation and catering as well as historic Mast Hall on Main Street. The attendees got a very good feel for how important azaleas are for Nacogdoches and SFA, and have been for 70 years.

2014 goal to develop plan for correcting erosion on the southern bank of Burrows Creek, on the northern end of the garden.—Yet to be defined; some solutions suggested, but not approved to move forward to construction. This erosion is just west of the wing walls and culvert improvements TxDOT made several years ago. Unfortunately, the erosion is occurring just past the TxDOT right-of-way, so it is an issue for SFA to correct.

Note: Four archival boxes of Ruby M. Mize Azalea Garden maps, azalea sourcing, and correspondence are now in the Steen Library Archives. I will add to these files if I find more material from my office at home. They particularly like scrapbooks and newspaper accounts, apparently.

For Gayla Mize Garden

Complete plant stake and plant labeling of entire collection. Process of mapping and listing plants needing labels about 70% done; creation of labels about 20% done, due to mechanical issues and nomenclature accuracy concerns.

Assist in sourcing new deciduous azaleas.—Yet to be done

Create visitor map and brochure in time for spring visitors.—Very basic level version done. Hand-drawn maps given to Dawn Stover so she could scan and work on the plant labeling and keeping track of plant collections.

Completed Major Projects:

Ordered and received 6 new for Jimmy Hinds Park Project on East Austin Street; locations yet to be designated and benches installed.

Ordered and received 2 new 6-foot metal benches for the Gayla Mize Azalea Garden to honor major donor Ray Mize; planned location at entrance to gazebo in gardens.

Other duties as assigned and completed

Assisted in writing, with SFA Development and Dr. Creech's project team, a proposal for \$300,000 for a 3-year project to assess woody plant material that can withstand high-salinity and occasional flooding by Moody Gardens in

Galveston, Texas. Involves a large team of SFA and ATCOFA faculty and graduate students, as well as a visiting Chinese scholar.

For Ruby M. Mize Azalea Garden

Led organization and execution of national Azalea Society of America convention March 26-29. — Done. A success.

Assisted with Nacogdoches Azalea Trail tours as needed during Azalea Trail 2016.

Get design proposal and cost estimate for roof to cover Council Ring. This would increase number of events that could be held there as well as reduce costs for Azalea Trail events. Budget permitting, begin construction.— Preliminary discussions with Physical Plant and Space Planning Group indicated this would be very costly and that would require several center poles that would limit functionality of the space. More cost-effective to rent tents each year for tea party weekends.

Set up a graveled and signed parking area by ROTC tower for staff parking.—Did not happen.

Improve irrigation in western-most bed (#45) and replace Encore® Azalea Collection losses. Did not happen.

Consider second pink “entrance sign” with map at western entrance to garden. Would be good to do, but would require flipping brochure design and about \$5,000. Do-able, and affordable, but not done.

For Gayla Mize Garden

Complete Pavilion roof on raised area by asphalt walk by well so area can be used for picnics and other gatherings.— Preliminary evaluations of plant and costs with Physical Plant that got approved by SFA Vice Presidents, but engineering and construction costs high. Tabled for the near term.

Purchase and install two metal benches in Pavilion.--Done

Complete individual plant-stake signs for all unique plant taxa. – On-going project.

Published Papers

Stump, Barbara. Fall 2014. 9 (3):3. “Get Ready for Azaleaphiles.” SFA Gardens News.

Stump, Barbara. Fall 2014. 9 (3):7. "A True Agricultural Legacy—Jimmy Hinds." SFA Gardens News.

Stump, Barbara. Spring, *The Azalean*. 36 (2): 28-44. "2015 ASA Convention: Texas Forest Country—Azalea Trails and Gardens."

Rodewald, Elyce and Stump, Barbara. Fall 2014 10 (3): 3. "In Memory: Ina Brundrett." SFA Gardens News.

Stump, Barbara. Winter 2014 9 (4): 5. "Plant Signs are for the Public." SFA Gardens News.

Stump, Barbara. Summer 2015 10 (2): 7. "Education Goes Both Ways with the ASA." SFA Gardens News.

Additional Publications

Two publications done to support azalea gardens in Nacogdoches and at SFA, done on vacation time:

Stump, Barbara. *Selected Azalea Hybrids*. 54 pages. 2015. SFA Press, Nacogdoches, Texas.

Stump, Barbara. *Azaleas of Nacogdoches*. 220 pages. SFASU Press, Nacogdoches, Texas.

Greg Grant

SFA Gardens Annual Report

September, 2014-August 2015



Presentations:

September 9, 2104. "Heirloom Gardening in the South" to the Lufkin Daylily Society in Lufkin. 26 in attendance.

September 11, 2014. "PNPC Fall Plant Sale Preview" to the SFA Gardens Lecture Series in Nacogdoches. 59 in attendance.

October 11, 2014. "Saving the World One Garden at a Time" to the Southern Garden Symposium in St. Francisville, Louisiana. 350 in attendance.

October 17, 2014. "Saving the World One Garden at a Time" to the Native Plant Society of Texas. 188 in attendance.

October 25, 2014. "Underutilized Plants for East Texas" to the East Texas Garden Lecture Series in Tyler. 65 in attendance.

November 6, 2014. "Gardening for Love" to the Writer's Literary Symposium at the Dallas Arboretum. 102 in attendance.

December 10, 2104. "Lessons Learned From My Grannies" to the Fort Bend County Master Gardeners' awards banquet. 138 in attendance.

January 28, 2105. "Corn and Sugar Cane Culture in the South" to the SFA Crop Science class in Nacogdoches. 30 in attendance.

January 31, 2105. "Native Perennials" to the Louisiana Native Plant Society in Pollock, Louisiana. 104 in attendance.

February 5, 2015. "Naturalizing Bulbs" to the SFA Annuals and Perennials class in Nacogdoches. 10 in attendance.

February 7, 2015. "Right Plant, Right Place" to the Louisiana Master Gardener Symposium in Ruston, Louisiana. 101 in attendance.

February 24, 2015. "A Lifetime of Gardening" to the East Texas Fruit and Vegetable Conference in Nacogdoches. 85 in attendance.

February 26, 2015. "The Gardens at Texas A&M" to the Texas Association of Botanical Gardens and Arboreta annual meeting at Nacogdoches. 97 in attendance.

March 12, 2015. "PNPC Spring Plant Sale Preview" to the SFA Gardens Lecture Series in Nacogdoches. 60 in attendance.

March 21, 2015. "The Greg Grant Signature Collection" at The Arbor Gate Nursery in Tomball. 21 in attendance.

March 16, 2015. "An Arcadian Dogtrot" to the Texas state Master Gardener Conference in Temple. 600 in attendance.

March 20, 2015. "Native Fruits and Nuts" to the Angelina County Master Gardeners natives lecture in Lufkin. 75 in attendance.

August 8, 2015. "Right Plant, Right Place" to the Sodbusters Symposium in Jasper, Texas. 110 in attendance.

Total Lecture Attendance: 2,221

Tours:

October 22, 2015. Afterschool program group tour on invasive plants at the PNPC. 13 in attendance.

February 25, 2015. Arcadia bulb and trillium tour to the Texas Association of Botanic Gardens and Arboreta in Arcadia. 17 in attendance.

March 25, 2015. Harrison County Master Gardener tour of the PNPC. 13 in attendance.

March 27, 2015. Azalea Symposium tour of Mary Beth Hagood's landscape. 76 in attendance.

March 31, 2015. Cherokee County Master Gardeners tour of the PNPC. 12 in attendance.

April 2, 2015. Crockett Garden Club tour of the PNPC. 23 in attendance.

April 8, 2015. Smith County Master Gardener tour of the PNPC. 15 in attendance.

May 9, 2015. Pine Savanna Bird Walk in Arcadia. 31 in attendance.

Total Tour Attendance: 360

Publications:

Grant, Greg. *The Arcadian Gardener*. **Magnolia**. Fall 2014. Volume XXVII. Number 4.

Grant, Greg. *Made in the Shade*. **Texas Gardener**. September/October 2014. Volume XXXIII. Number 6.

Grant, Greg. *Leaping Lizards*. **Neil Sperry's Gardens**. September/October 2014. Volume XXVII. Issue 5.

Grant, Greg. *Caroline Dorman*. **Texas Gardener**. November/December 2014. Volume XXXIV. Number 1.

Grant, Greg. *The Yaupon Hollies*. **Neil Sperry's Gardens**. November/December 2014. Volume XXVIII. Issue 6.

Grant, Greg. *Propagating at the PNPC*. **SFA Gardens News**. Winter 2014-2015. Volume 9. Issue 4.

Grant, Greg. *Roses from the Heart*. **Texas Gardener**. January/February 2015. Volume XXXIV. Number 2.

Grant, Greg. *Success by Design*. **Neil Sperry's Gardens**. January/February 2015. Volume XXIX. Issue 1.

Grant, Greg. *Friends Who Keep Growing*. **Texas Gardener**. March/April 2015. Volume XXXIV. Number 3.

Grant, Greg. *Repeat After Me*. **Neil Sperry's Gardens**. March/April 2015. Volume XXIX. Issue 2.

Grant, Greg. *My Dog Rosie Lives in a Tree!* **Texas Blues**. May 2015. Volume 14. Issue 2.

Grant, Greg. *Crapemyrtles-Rooted in Love*. **Texas Gardener**. May/June 2015. Volume XXXIV. Number 4.

Grant, Greg. *Look at Me Now*. **Neil Sperry's Gardens**. May/June 2015. Volume XXIX. Issue 3.

Grant, Greg. *Home on the Range*. **Texas Gardener**. July/August 2015. Volume XXXIV. Number 5.

Supervised 8 volunteers for 224 hours

Dawn Stover

Research Associate SFA Gardens

September 1, 2014 – August 31, 2015



September 4, 2014 – “Sexy Plants” – presentation, Smith County Master Gardeners. 100 attendees

September 11, 2014 – “Plant Sale Preview” – Les and Theresa Reeves Lecture Series. 59 attendees

September 13, 2014 – “Propagation Station” – workshop, SFA Gardens Saturday Seminar. 25 attendees

October 4, 2014 – Fabulous Fall Festival – SFA Gardens plant sale. Over 500 attendees

October 7, 2014 – SFA Agriculture College Day – SFA Gardens activities recruiting high school students. 50 attendees

October 14, 2014 – “Chrysanthemums at the SFA Gardens” – presentation to Four Seasons Garden Club. 30 attendees

November 1, 2014 – Texas Arbor Day – coordinate local tree planting event: impact planting of Chinese fringe trees, an assorted natives at Banita Creek Park, North, Nacogdoches. 40 volunteers

November 1, 2014 – Fall Fandango – coordinate SFA Gardens membership event. 30 attendees

November 3, 2014 – Community Outreach – tree pruning demonstration for city employees. 15 attendees

December 6, 2014 – “Deck the Halls” – workshop, SFA Gardens Saturday seminar. 25 attendees

January 19, 2015 – “Taking the Myth Out of Urban Farming: How to Grow Vegetables in Your Backyard” – presentation, Angelina County Master Gardeners’ speaker series. 50 attendees

January 26, 2015 – Guest lecture, SFA Crop Science lab. 25 attendees

January 27, 2015 – Guest lecture, SFA Herbaceous Plants class. 10 attendees

January 28, 2015 – Guest lecture, SFA Crop Science lab. 25 attendees

January 31, 2015 – “Veggies 101” – workshop, SFA Gardens Saturday Seminar. 25 attendees

February 25, 2015 – Texas Association of Botanical Garden and Arboreta annual conference. Organize/host and attend conference held at SFA Gardens

March 7, 2015 – FFA Career Development Event, Nursery and Landscape competition – Houston Livestock Show and Rodeo. 125 attendees

March 12, 2015 – Annuals and Perennials short course – Nacogdoches, Angelina and Cherokee County Master Gardener trainees. 20 attendees

March 25, 2015 – Arboretum tour - Annahuac High School. 17 attendees

March 25, 2015 – Arboretum tour - Harrison County Master Gardeners. 20 attendees

April 11, 2015 – Garden Gala Day, SFA Gardens plant sale. Over 500 attendees

April 13, 2015 – FFA Career Development Event, Nursery and Landscape competition – SFA invitational. 100 attendees

April 16, 2015 – Arboretum tour – Leadership Nacogdoches. 50 attendees

April 17, 2015 – Sculpture for All 2015-17, opening reception. 75 attendees

June 18, 2015 – Arboretum tour - FUMC Prime Timers. 60 attendees

June 26, 2015 – SFA Gardens Industry Day – organize and host event. Sponsored by Bailey Nurseries. 65 attendees

August 8, 2015 – “Gardening for Pollinators” – presentation - Sod Busters Conference, Jasper County Master Gardeners and Master Naturalist. 100 attendees

Stover, Dawn. 2015. Notes from SFA Gardens – Eyeing the Paparazzi. Jul/Aug 2015 TNLA Green 17 (4): 57-59

Professional Development

February 25-27 – Texas Association of Botanical Garden and Arboreta, annual conference, Nacogdoches, TX

July 27-29 – Perennial Plant Association, annual conference, Baltimore, MD

SFA Training

Security Awareness training

Professional Achievements

Edit SFA Gardens News, quarterly newsletter for the SFA Garden's members

Successfully completed fundraising campaign for outdoor sculpture competition and brought Sculpture for All exhibit to the SFA Gardens

Service

As part of my responsibilities, I supervise a volunteer corps that accomplished 1440 hrs of volunteer time, equivalent to a contribution of \$32,328.00

First United Methodist Church, Board of Trustees

Nacogdoches Junior Forum: Membership Chair, Arts & Historic Committee member

Garden Capital of Texas Committee

Healthy Nacogdoches Coalition

Elyce Rodewald
Environmental Education Programming
September 1, 2014 – August 31, 2015

Education Team

Coordinator: Elyce Rodewald



Assistant Coordinator: Kerry Lemon

Student Workers: Brandy Sapp, Aubrey Baker, Anthony Rosborough, Cassandra Zick, Trenton Stiefel, Emily Greenstein, Kemecia Shed

Intern: Brittany Hernandez

Education Assistants: Vicki Baggett, Ariel Jones, Michelle Clark, Paige Christopher, Justin Clark, Robert Hearne, Jocelyn Moore, Ruth Talbot

SFA Garden Volunteers: Jackie Grant, Ray Goehring, Kathy Greer, Mary Beth Hagood, Ruth Heino, Kay Jeffrey, Mary Louise Jobe, Marianne Young

Presentations

Coordinated and/or presented educational programs for SFA Gardens for over 18,000 participants. See table below.

Highlights include twice weekly after-school programs for Boys and Girls Club Members and Raguet Elementary School students, hands-on environmental education field trips for all Nacogdoches ISD elementary students grades K-5, outdoor family fun days, bi-monthly garden seminars, five weeks of summer camps and special events including the Little Princess Tea Party and two FFA Career Development Events (horticulture judging contests).

Publications

Rodewald, Elyce. "Notes from SFA Gardens: Planting Seeds, One Child at a Time." *TNLA Green* (Sept. –Oct. 2014): 29-31. Print.

SFA Student Involvement

Environmental Education programs at SFA Gardens advanced the University mission by enhancing excellence in teaching, learning, creative work and service and by creating new learning opportunities for SFA students. Three students completed required internships by participating as teachers in the after-school program or summer camp experience. Students enrolled in Dr. Alan Soward's and Leah Kahn's science methods courses also gained hands-on experience in curriculum development and instruction in an outdoor classroom through their participation in Bugs, Bees, Butterflies and Blossoms and Wild About Science.

Community Partners

Pineywoods Audubon Society, Boys and Girls Club of Nacogdoches, Texas Forest Service, Boyette Consulting, City of Nacogdoches Parks and Recreation Department, Keep Nacogdoches Beautiful, Pineywoods Beekeepers Association, Texas Parks and Wildlife Department, US Forest Service, Nacogdoches Junior Forum, Nacogdoches Boys and Girls Club

Training

At SFA, attended Receipts and Deposits, Property Management and security training.

Attended grant management workshop in Austin, TX. Attended TABGA meeting at SFA.

Service

No service—on family medical leave May, June, July and August

I supervise a number of Volunteers that include:

300 -Nacogdoches Naturally

198 - Learning Excursions

960 - BBBB

120 - Forest Awareness Tours-120

125 - Earth Day

1703 total hours with a value of \$38,249

Grants and Funding

Received George and Fay Young grant for conservation education program support.

Managed Texas Parks and Wildlife COOP grant.

Managed SFA Garden Membership drive and supervised collection of fees for educational programs.

SFA Gardens Environmental Education Program Data Summary

	2001-2002	2002-2003	2003-2004	2004-2005	2005-2006	2006-2007	2007-2008	2008-2009	2009-2010	2010-2011	2011-2012	2012-2013	2013-2014	2014-2015
Adult Programs														
Arboretum/Azalea Garden/PNPC Tours	744	744	768	1334	1214	1343	863	1244	1499	908	460	1278	912	690
Les Reeves Lecture Series	980	860	709	823	922	751	824	789	811	780	802	809	982	820
Garden Seminars	83	158	184	175	32	45	57	65	32	145	396	142	206	178
Educator Workshops	24	186	23	121	183	225	455	110	160	30	43	88	0	147
Volunteer Training	25	35	13	45	29	11	30	18	10	8	12	26	11	0
Adult Special Events	1285	1927	1070	1508	1200	3281	1862	1350	1020	987	300	254	0	88
Lectures-outreach							3179	4232	2905	2388	3437	4738	5169	6189
Sub-total	3141	3910	2767	4006	3580	5656	7270	7808	6437	5246	5450	7335	7280	8112
Children's Programs														
Arboretum Adventures	917	546	820	733	1048	1120	771	1162	1377	784	546	514	588	543
Trees Are Terrific	2320	1246	962	622	1784	1750	2072	1795	552	921	717	0	0	0
Forest Awareness						450	600	1050	1200	1900	535	613	600	571
GardenQuest	398	644	381	0	525	182	316	80	320	175	0	28	120	130
Go Wild	174	690	924	549	711	772	803	752	549	540	499	473	495	521
Wild About Science (Go Native Field Day)	0	0	250	300	594	594	508	351	483	479	525	452	446	455
Earth Science Exploration						475	475	612	1076	869	796	447	462	520
School Gardening	66	0	0	0	0	0	0	120	0	0	0	473	495	0
Bugs, Bees, Butterflies and Blossoms	500	1000	2025	2640	2574	2816	2800	2800	2477	3292	3301	3523	3279	3395
Pineywoods Day Camps	26	26	36	58	63	67	74	77	77	83	87	87	91	102
Children's Special Activities	571	1056	1538	1756	2004	200	350	800	882	115	804	2120	1902	1023
Wild About Wetlands	0	0	0	87	154	395	111	46	19	28	27	30	100	106
Nacogdoches Naturally-Family Day								193	520	500	893	1753	1888	1040
CDE (Career Development Education)						700	686	511	704	772	897	845	700	800
Nacogdoches Naturally-After school									503	495	648	1138	938	916
Sub-total	4972	5208	6936	6745	9457	9521	9566	10349	10739	10953	10275	12496	12104	10122
Total	8113	9118	9703	10751	13037	15177	16836	18157	17176	16199	15725	19831	19384	18234

Data shown are from September through August each year.

Kerry Lemon
Assistant Education Coordinator
September 1, 2014 – August 31, 2015



Part time:

Fall: September 17- December 11, 2014

Spring: January 14 – May 7, 2015

Weekend Outdoor Adventures:

September 6, 2014: Kick-off Day – PNPC

September 27, 2014: Solid Foundation –
Hiking the trails/Gayla Mize – Mammal
program/PNPC

October 4, 2014: Solar Saturday - PNPC

November 8, 2014: Solid Foundation – Art in the Garden-Azalea Garden/Arbor
Day Tree planting-Banita Creek Park

January 24, 2015: Kid Fish – Solid Foundation/Community event

February 14, 2015: Backyard Bird Count- PNPC

April 11, 2015: Earth Day Celebration – PNPC

April 25, 2015: Farm and Forestry Day – SFA Beef Center

May 2, 2015: Solid Foundation – Experimental Forest

National Archery in the Schools program

October 6-10, 2014: Mike Moses Middle School

April 6-10, 2015: McMichael Middle School

May 11, 14, 2015: Mike Moses Middle School

Photography Workshop for Boys and Girls Club

February 3, 10, 17, 24; March 3, 10, 24; April 7: Tuesday afternoons

July 23, 2015: Photography Art Opening – Cole Art Center

SFA Pineywoods Camps

June 8-12, 2015: Wonder Woods

June 15-19, 2015: Jack Creek 1

June 22-26, 2015: Jack Creek 2

July 6-10: Solid Foundation Camp – Jack Creek 3

July 13-17, 2015: Wilderness Adventures

Educational field trips

Fall 2014

Spring 2015

Other:

February 18-20, 2015: Attended Informal Science Educators Association Conference

February 25-26, 2015: TABGA

March 11, 2015: SFA Wellness Fair

Attended Healthy Nacogdoches Coalition meetings

Trainings:

P-card Training, First Aid/CPR

DUKE PITTMAN

Duke Pittman is our lead Arboretum Technician. He is responsible for organizing the work load of our student assistants in the garden, irrigation, landscape maintenance, project development and keeping staff morale high.

BROCK VINSON

Brock Vinson SFA Gardens Technician in his first year provided excellent on the ground supervision of a wide range of projects.